

UNITEDWORLDTM
institute of design

ADMISSIONS 2015

UNDER GRADUATE

TOTAL NO. OF PAGES - 10
TOTAL MARKS – 100

Permitted Time: 3 hours

Kindly read the instructions carefully before attempting the questions.

To be filled by the student.

| | | |
|---------------------|---|--|
| CANDIDATE ID | : | |
| CANDIDATE NAME | : | |
| TEST CENTRE | : | <input type="checkbox"/> AHMEDABAD <input type="checkbox"/> MUMBAI <input type="checkbox"/> KOLKATA <input type="checkbox"/> DELHI |
| CANDIDATE SIGNATURE | : | |

OBSERVER'S SIGNATURE:

To be filled by the office only.

INSTRUCTIONS TO CANDIDATES:

Read these instructions carefully.

1. Write your name, Candidate ID number and the Examination Centre in the space provided on the cover page of this answer book as well as all the pages of answer book.

- Make sure that you sign in the space provided on the cover page.
- No distinctive mark of any sort is to be put anywhere in the answer book.
- Violation of these instructions or adoption of malpractices in the examination hall will lead to disqualification.
- Please make sure you have signed the registration sheet with invigilator to mark your presence.

2. Write your answers ONLY IN ENGLISH.

3. ALL QUESTIONS ARE TO BE ATTEMPTED.

4. Write or draw your answers only in the space provided for each question.

- Backside of the paper to be used for ROUGH WORK ONLY. The final answer should be provided ONLY in the space marked as "SPACE for Final answer".

5. DO NOT REMOVE ANY SHEET from this answer book.

6. Before leaving the examination hall, submit this question-cum-answer paper to the invigilator.

QUESTION: 1

IDENTIFY THE RIGHT LOGO AND NAME OF THE COMPANY IT REPRESENTS.
ALSO TICK-MARK THE WRONG ONE.



Right Wrong

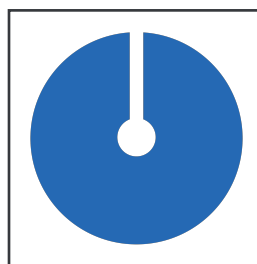

Right Wrong

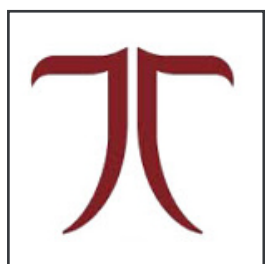

Right Wrong

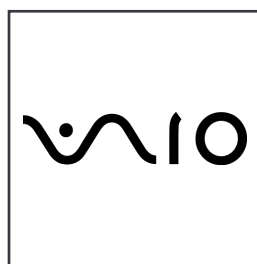

Right Wrong

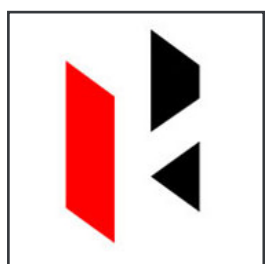

Right Wrong

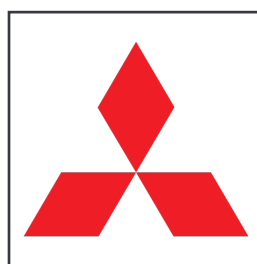

Right Wrong

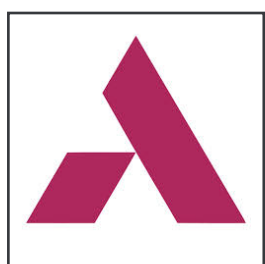

Right Wrong



Right Wrong



Right Wrong



Right Wrong

QUESTION: 2

MARKS
15

DRAW AN ADULT HUMAN IN ACTION IN GIVEN DRAWING.

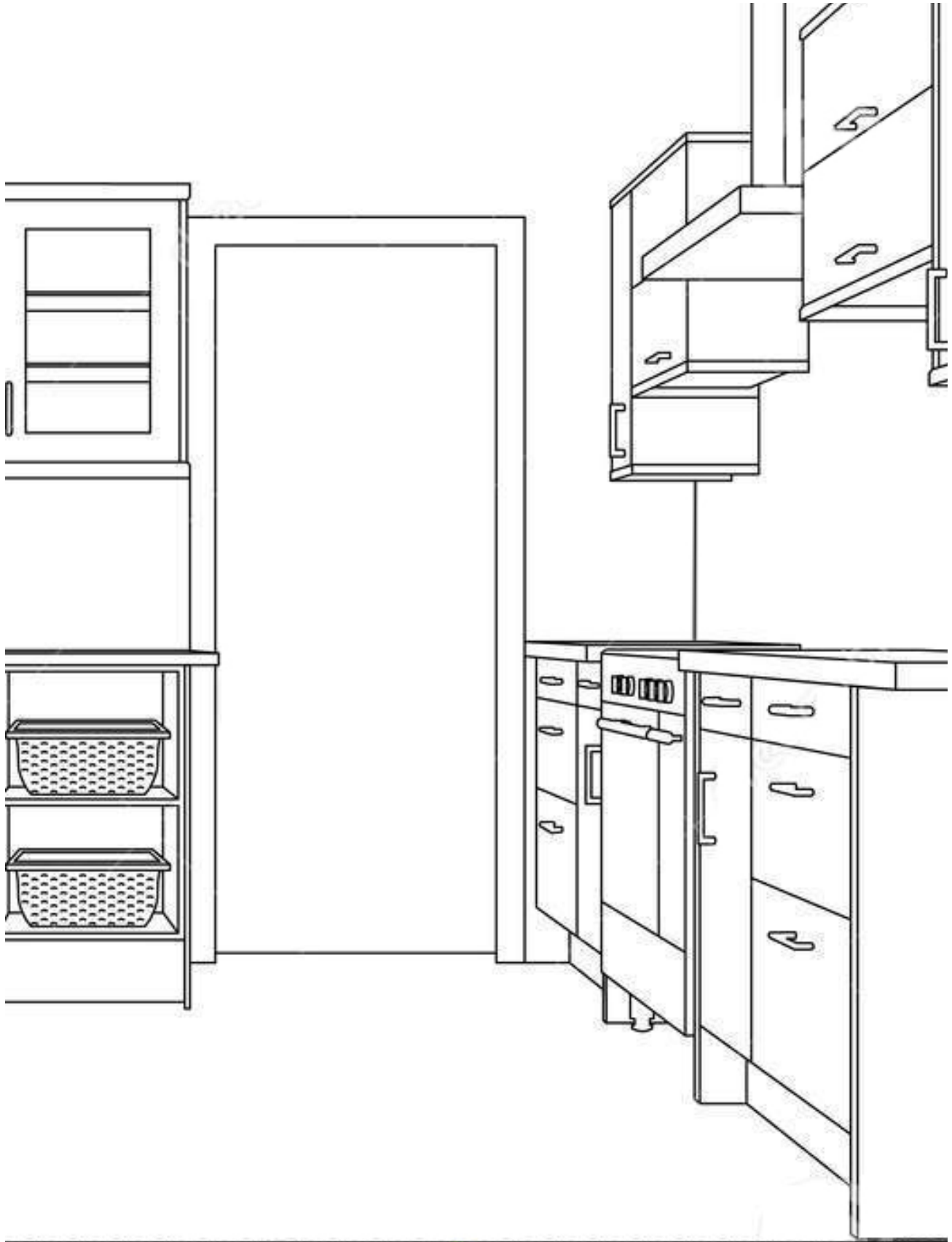

QUESTION: 3

MARKS
10

PLACE A HANDLE, STOPPER, WIND LATCH AND INDICATE THE PLACE OF A HINGE ON THE GIVEN WINDOW. USE PENCIL ONLY. YOU MAY DO PENCIL RENDERING.

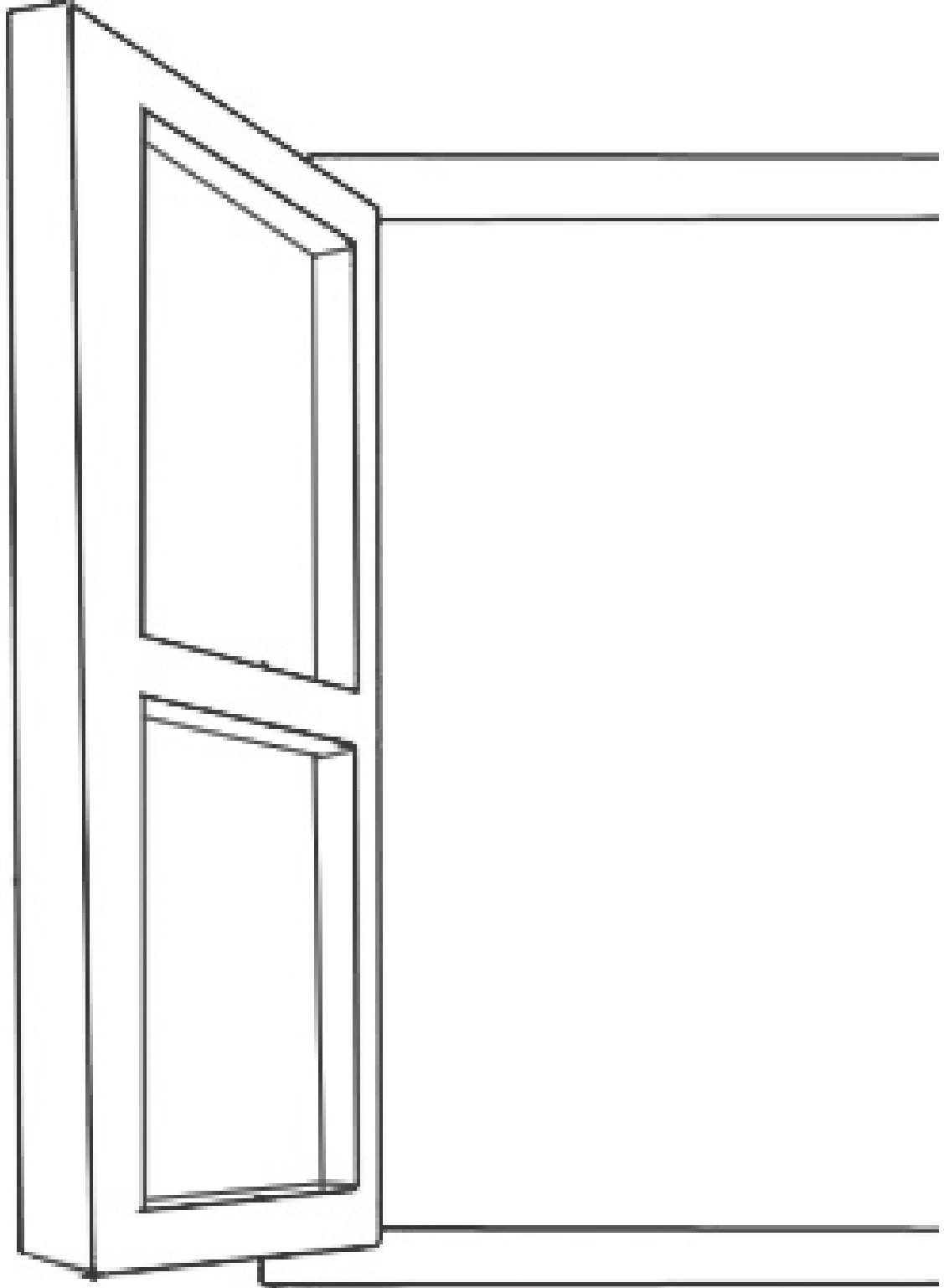

QUESTION: 4

MARKS
20

VISUALISE THE INCOMPLETE LINES AND COMPLETE A DRAWING WITH DETAIL.

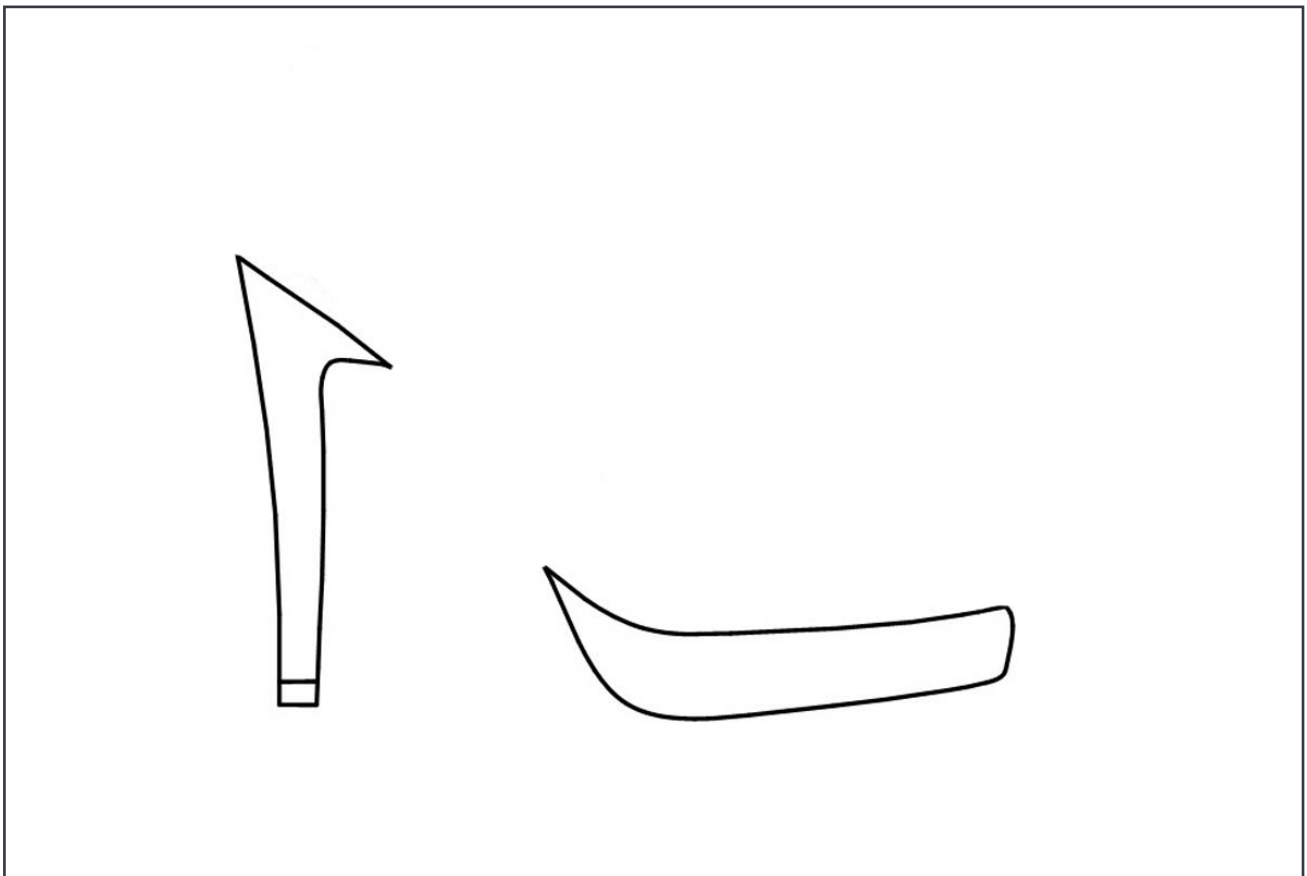
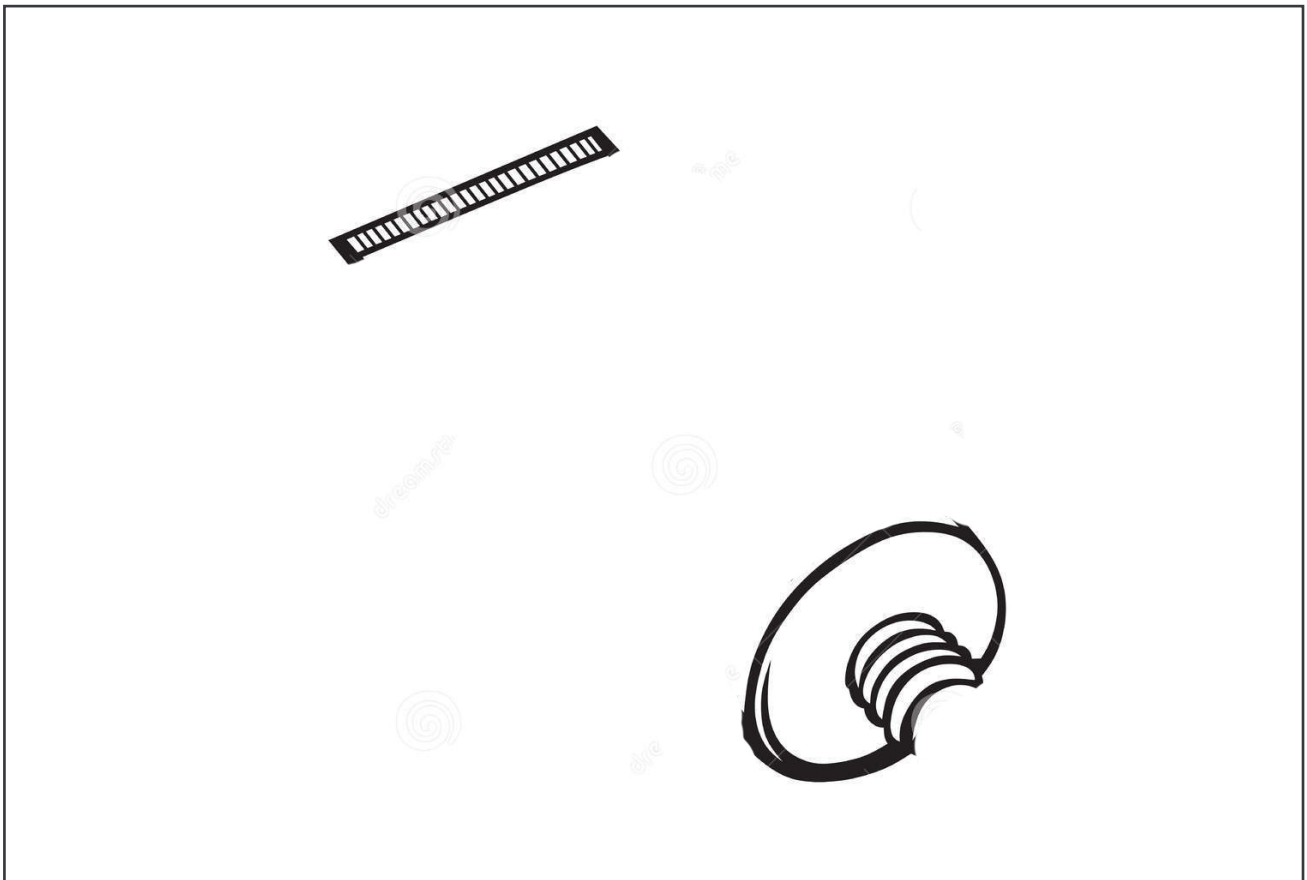

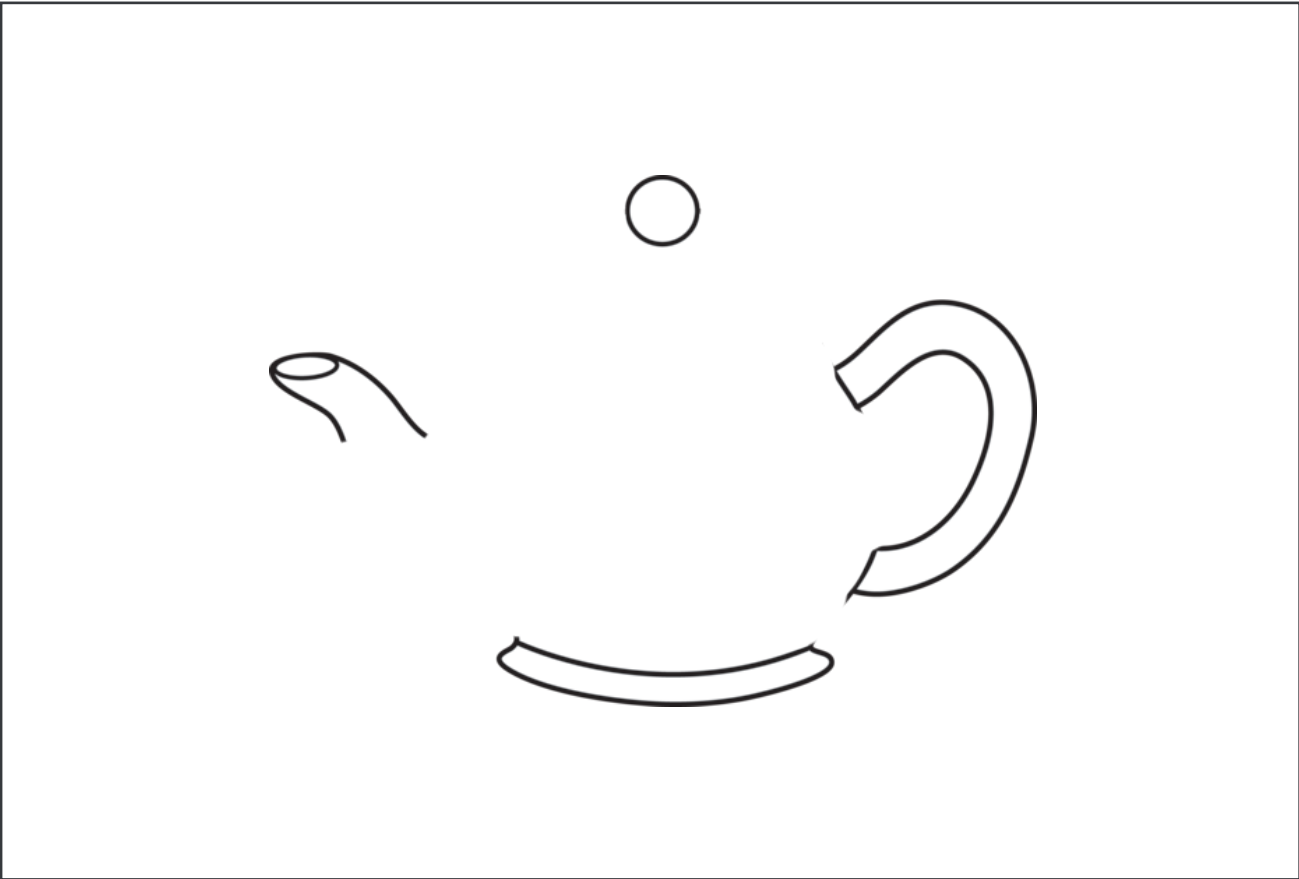
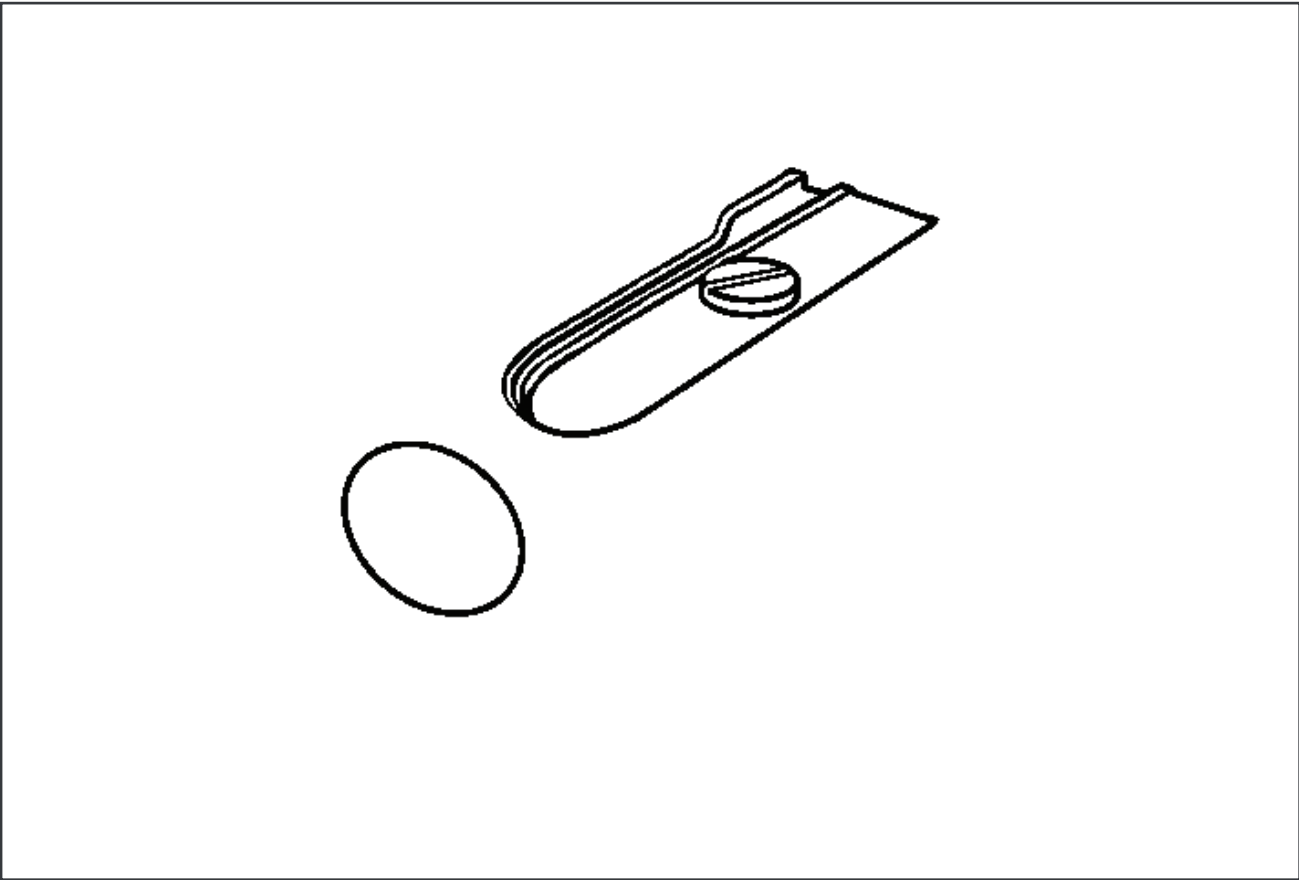

QUESTION: 5

MARKS
10

A LIGHT SOURCE MARK IS GIVEN ON OBJECT WHERE THE SHADOW WILL FALL AND HOW IT WILL LOOK? USE PENCIL ONLY.

LIGHT SOURCE

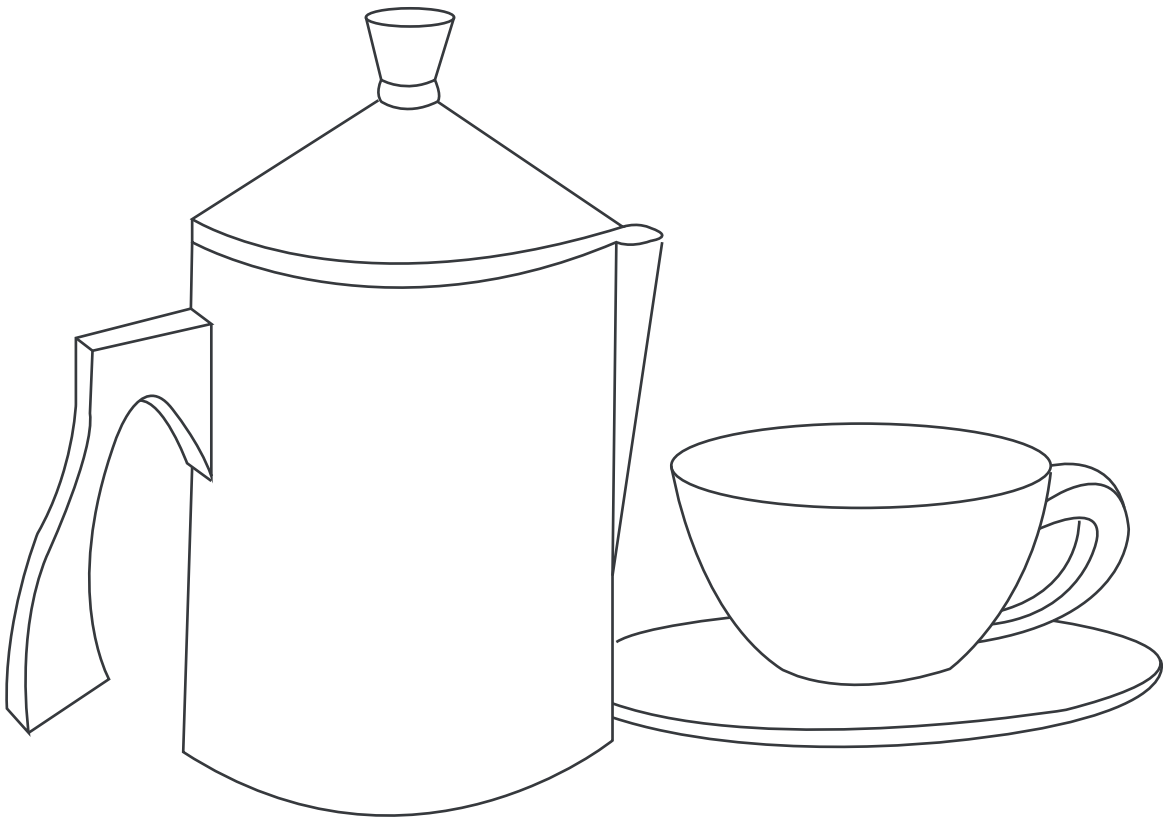

QUESTION: 6

MARKS

25

CREATE A SCENIC COLLAGE FROM BIRD EYE VIEW OF "SUNSET OR SCENIC ARCHITECTURE OR LANDSCAPE" IN AN ABSTRACT MANNER BY USING GIVEN COLOR PAPERS (ALSO DESCRIBE THE SCENE IN A FEW WORDS). TEAR PAPERS WITH HAND ONLY. YOU MAY CRIMP ALSO TO GIVE TEXTURE EFFECT.

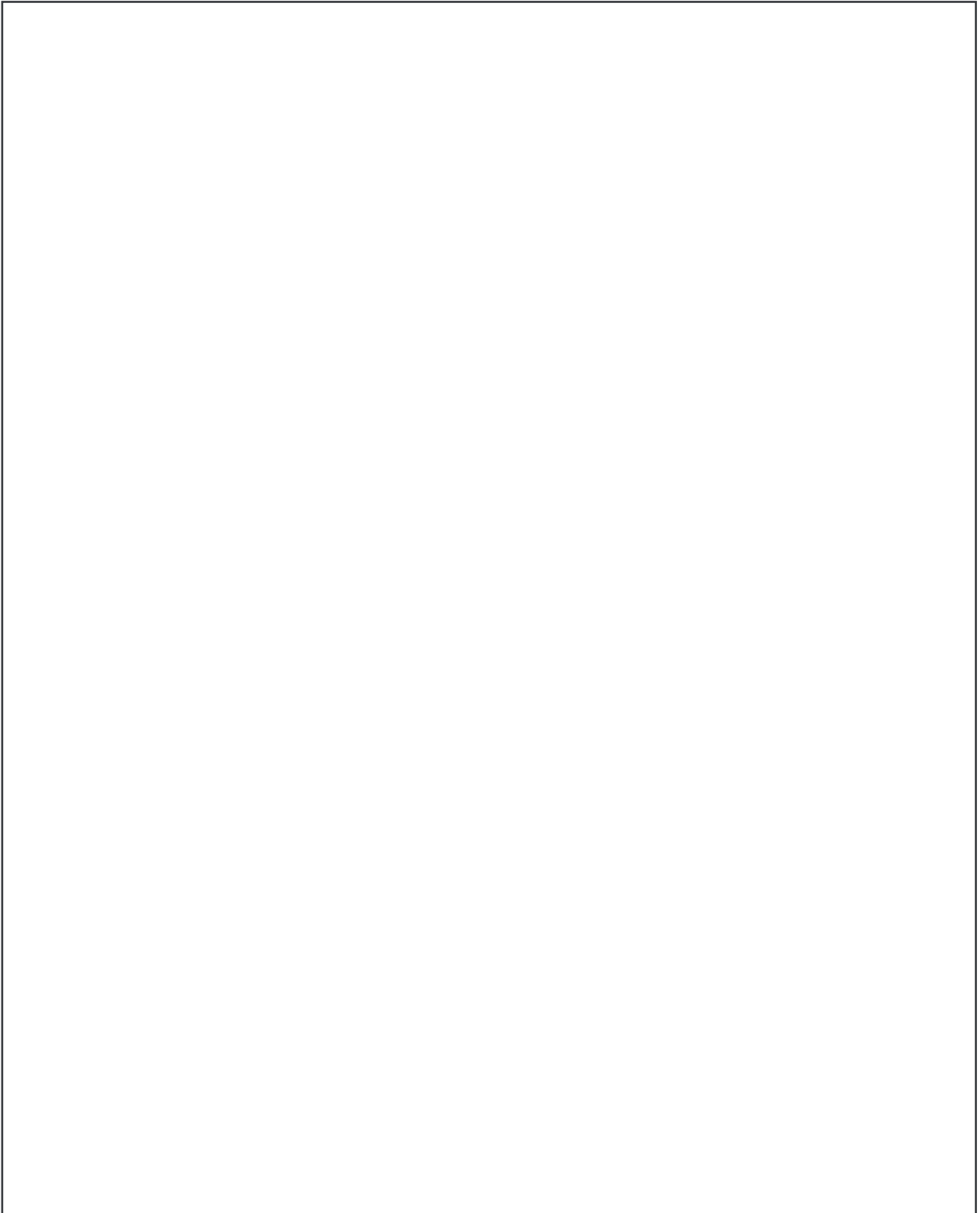

QUESTION: 7

MARKS
10

FROM THE GIVEN 3 DIMENSIONAL VIEW DRAW THE SAME OBJECT, VIEWED FROM DIFFERENT ARROW AS SUGGESTED BY ARROW. CHOOSE ANY ONE DIRECTION.

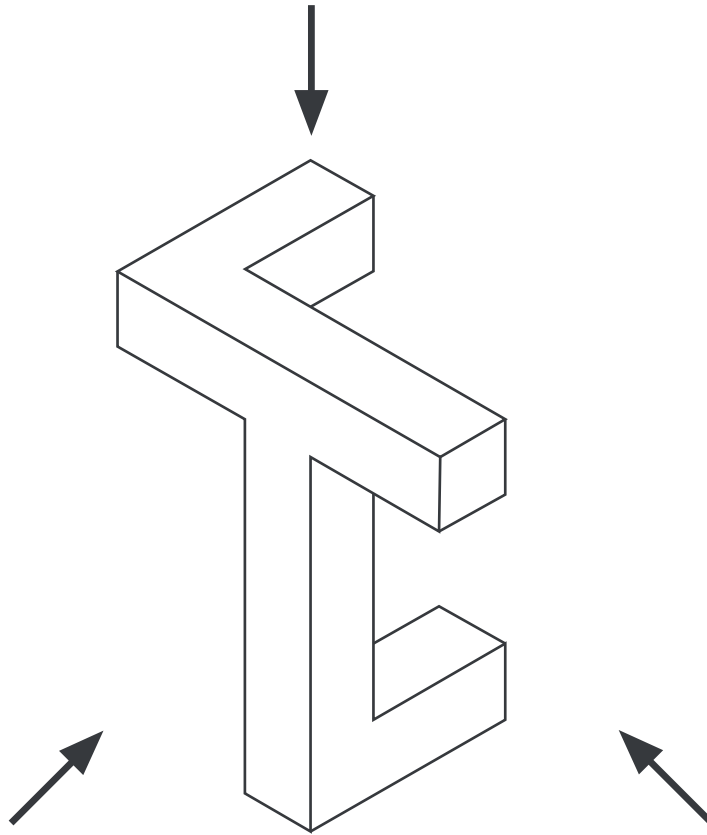

DRAW HERE